

CORNER RECORD

Document Number CR 6061

City of Oakland County of Alameda, California

Brief Legal Description City of Oakland Monument. 23/E/8

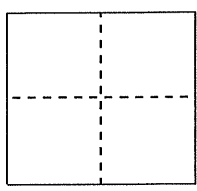

CORNER TYPE

Government Corner ☐ Control ☐
 Meander ☐ Property ☐
 Rancho ☐ Other ☒

Date of Survey January 15, 2014

COORDINATES (Optional)

N. _____
 E. _____
 Zone _____ NAD27 ☐ NAD83 ☐
 NAD83 Epoch _____
 Elev. _____
 Vert. Datum: NGVD29 ☐ NAVD88 ☐
 Meas. Units: Metric ☐ Imperial ☐

Corner - Left as found ☒ Found and tagged ☐ Established ☐ Reestablished ☐ Rebuilt ☐

Identification and type of corner found: Evidence used to identify or procedure used to establish or reestablish the corner:

In compliance with Section 8771 of the Professional Land Surveyors' Act, this corner record is being filed to ESTABLISH the position of an existing monument PRIOR to street or highway construction.

A description of the physical condition of the monument as found and as set or reset:

See sketch on back

SURVEYOR'S STATEMENT

This Corner Record was prepared by me or under my direction in conformance with the Professional Land Surveyor's Act on January 16, 2014

Signed [Signature] P.L.S or R.C.E. No. LS 7059

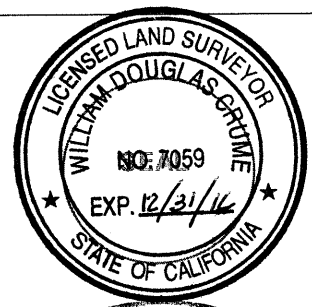

COUNTY SURVEYOR'S STATEMENT

This Corner Record was received 1-21-15 and examined and filed 6-26-15

Signed [Signature] P.L.S or R.C.E. No. 5726
 Title COUNTY SURVEYOR

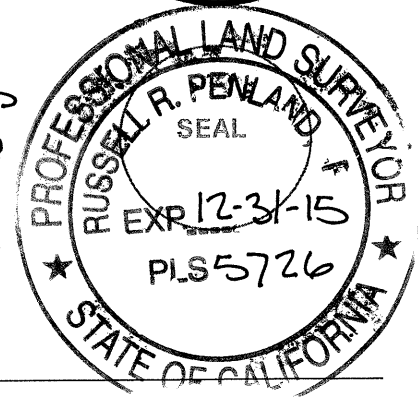

County Surveyor's Comment: _____

