

# DWD XP

## Pot drawer H95 with round quick-mounting railing



- Tool-free railing installation
- Fully synchronised slide technology without mid-way knock
- Excellent running characteristics
- Maximum stability
- Minimal drawer deflection
- Integrated side and eccentric height adjustment including locking screw
- Tool-free tilt angle adjustment using round railing
- Stable front holder
- Removal and transport protection
- Bottom panel machining not required

- Width of bottom and back panel is the same
- All add-on systems can be retrofitted

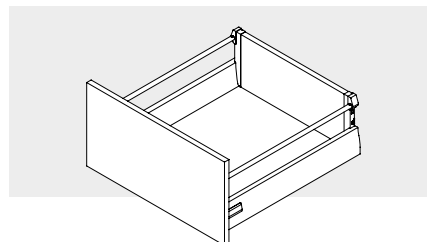

### ORDER INFORMATION

#### 1 DWD XP drawer sides H95 incl. cover caps

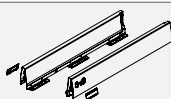

NL	Aluminium metallic		
350	F090075285		
400	F090075289		
450	F090075293		
500	F090075297		
550	F090075301		
600	F090075305		
650	F090075308		

#### 2 DWD XP full extension drawer slides with Soft-close

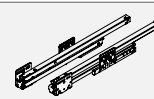

NL	40 kg	60 kg	
350	F091075474	–	
400	F091075475	–	
450	F091075476	F091075528	
500	F091075477	F091075529	
550	F091075478	F091075530	
600	–	F091075531	
650	–	F091075532	

#### 3 Clip set for wooden back panel H182



	Aluminium metallic		
	F092082943		

#### 4 Front holder

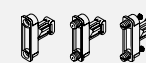

	Screw fixing	Press fitting	Expansion dowel
	F092083116	F092083117	F092083119

#### 5 Quick-mounting railing set

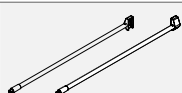

NL	Aluminium metallic		
350	F092075962		
400	F092075974		
450	F092075989		
500	F092082405		
550	F092082420		
600	F092082429		
650	F092082435		

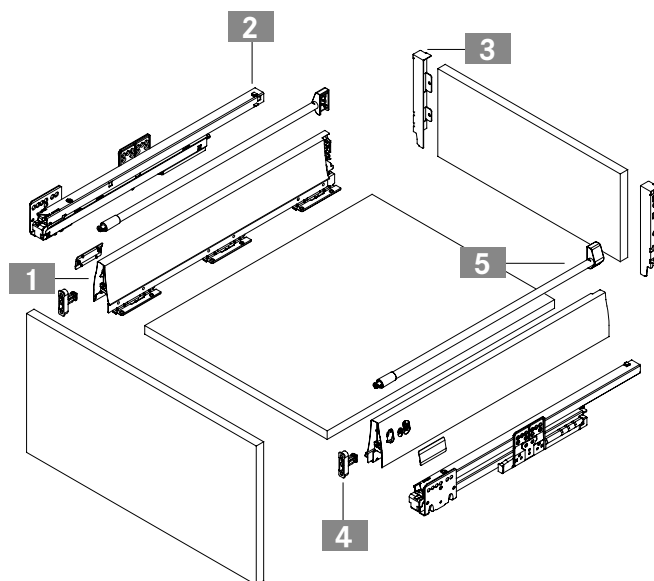

DWD XP Variowing	590
DWD XP round railing divider	598

DWD XP organising systems	600
DWD XP Tipmatic Plus	582

Technical information	584
DWD XP Sensomatic	613

## INSTALLATION INFORMATION

All dimensions in millimetres

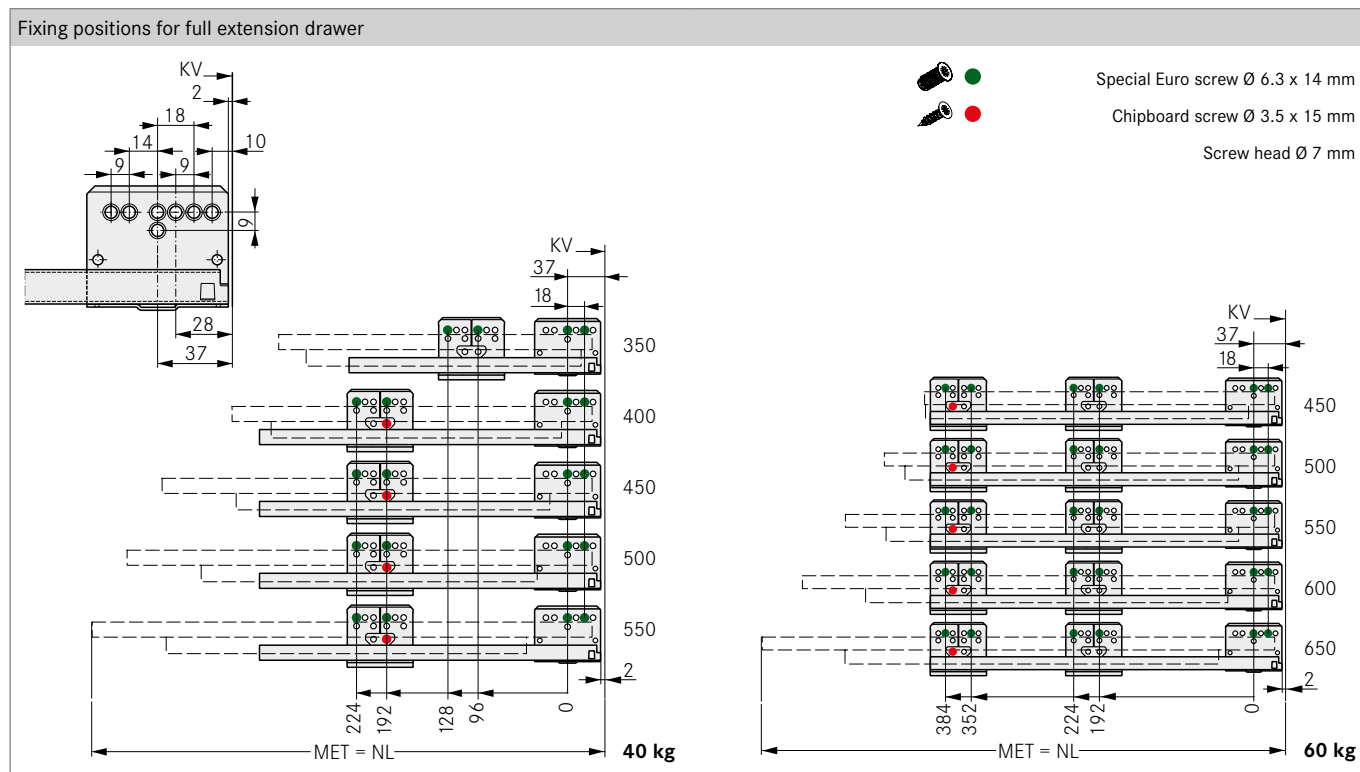
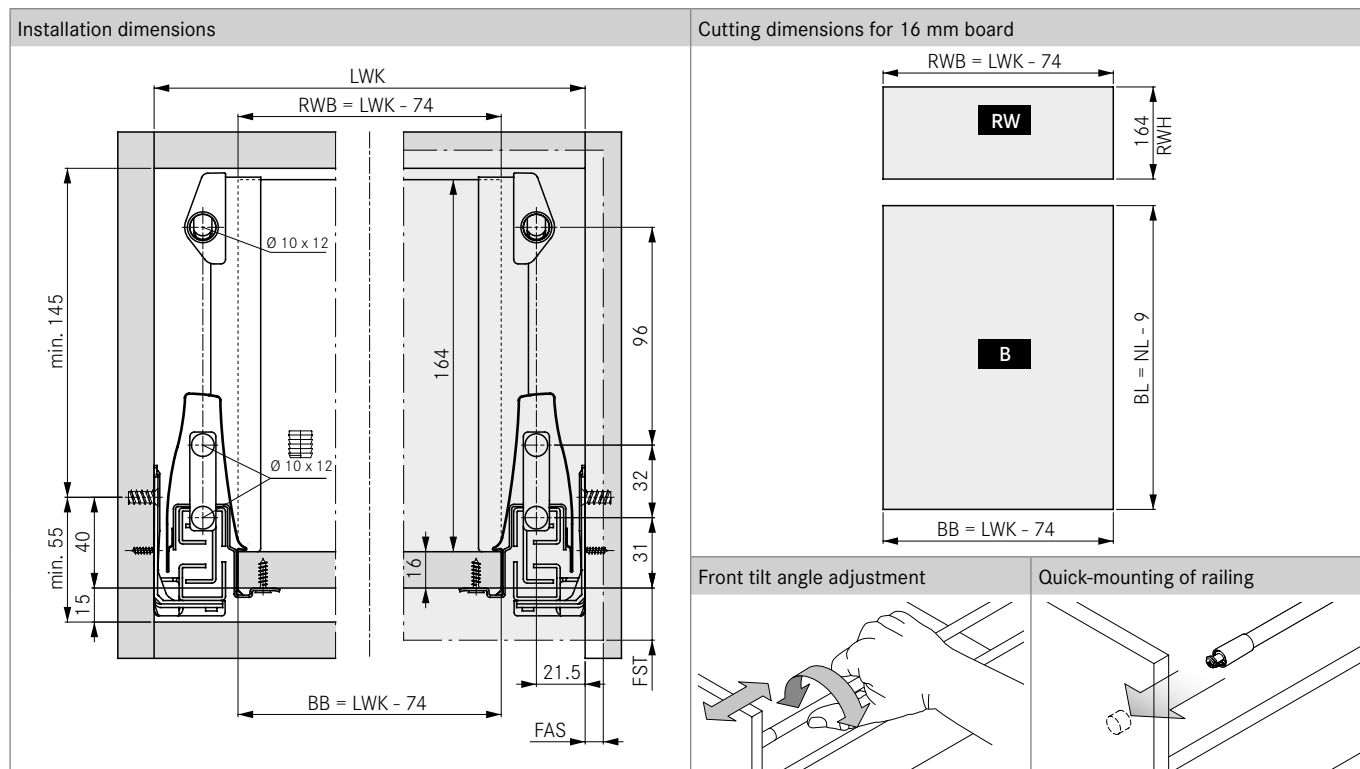

## LEGEND

**B** Bottom panel  
**BB** Bottom panel width  
**BL** Bottom panel length  
**FAS** Front overlay, side

**FST** Front overlay  
**KV** Front edge of cabinet  
**LWK** Inside cabinet width  
**MET** Minimum installation depth

**NL** Nominal length  
**RW** Back panel  
**RWB** Width of back panel  
**RWH** Height of back panel