

County Surveyor Office
Stanislaus County Cal.

Swamp and Overflowed Lands
Survey No 131

Township Four South

Range Eight East

Section Eleven, all between the
left bank of the Tuolumne River
in the South $\frac{1}{2}$ of Section Eleven.

Base and Meridian of Mount
Diablo. Containing 17.36 Acres

Surveyed Feby. 16th 1860 for

John H. Carpenter

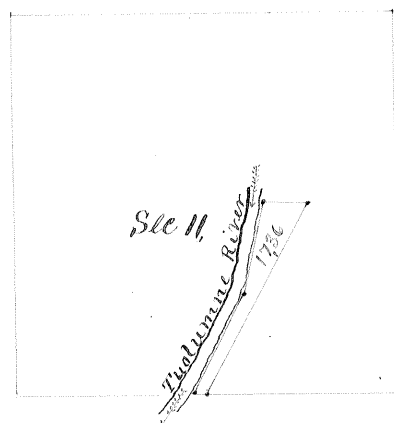

Scale $\frac{1}{2}$ Mile to 1 inch

Done in full

Field Notes:

Beginning at meander post on line between Sections 11 & 14
Thence run on the United States meander line $N 28^{\circ} E 45.31$ ch. to
 $\frac{1}{4}$ Section line. Thence run on $\frac{1}{4}$ section line West 9 ch. to the left bank
of the Tuolumne River, meander down stream, run $S 12\frac{1}{2}^{\circ} W 20.00$ ch.
 $S 27\frac{1}{4}^{\circ} W 23$ ch. to Section line between Sections 11 & 14 run on Section
line East 2.61 ch. to the place of beginning.

Run by the true Meridian: Magnetic Variation, 15.45 East.

Surveyed in accordance with the act of the Legislature con-
cerning Swamp and Overflowed Lands, approved April 18th 1859
and the instructions of the Surveyor General

Silas Wilcox

County Surveyor Stanislaus County

Approved March 5th 1860

W. A. Higley

Surveyor General

Recorded May 7th 1860

Silas Wilcox

County Surveyor

Stanislaus County