

CORNER RECORD

COUNTY OF INYO MONO T. 6N R. 26E Mt Diablo BSM MERIDIAN CALIFORNIA
 CORNER TYPE: GOV'T. CORNER ☒ MEANDER ☐ RANCHO ☐ CONTROL ☐ OTHER ☐
 CORNER IDENTIFICATION - DATE OF VISIT July 21 19 83

S16	S15
S21	S22

CORNER - LEFT AS FOUND ☐ FOUND AND TAGGED ☐ REESTABLISHED OBLITERATED CORNER ☐ REBUILT ☒

PHYSICAL DESCRIPTION OF CORNER FOUND: EVIDENCE AND METHOD USED TO IDENTIFY OR REESTABLISH Found 4" square post, badly weathered, in large mound of stones still intact. Made search for bearing trees, located one. Corner description and bearing tree match original field notes.

PHYSICAL DESCRIPTION OF MONUMENTS REBUILT OR PERPETUATED Replaced post with a 2 1/2"x3" aluminum pipe with cap, cemented in the ground. Cap stamped according to the "Manual of Surveying Instructions" (Section 4-23 through 4-45 in the 1973 Manual).

CALIFORNIA COORDINATE SYSTEM ORDER: FIRST ☐ SECOND ☐ THIRD ☐
 STATIONS USED: NGS (USC & GS) ☐ STATE ☐ COUNTY ☐ OTHER ☐ STATION _____ STATION _____
 ZONE _____ ELEVATION _____ NORTHINGS (Y) _____ EASTINGS (X) _____

SKETCH: (Include reference tie or witness points, remarks and topo of area)

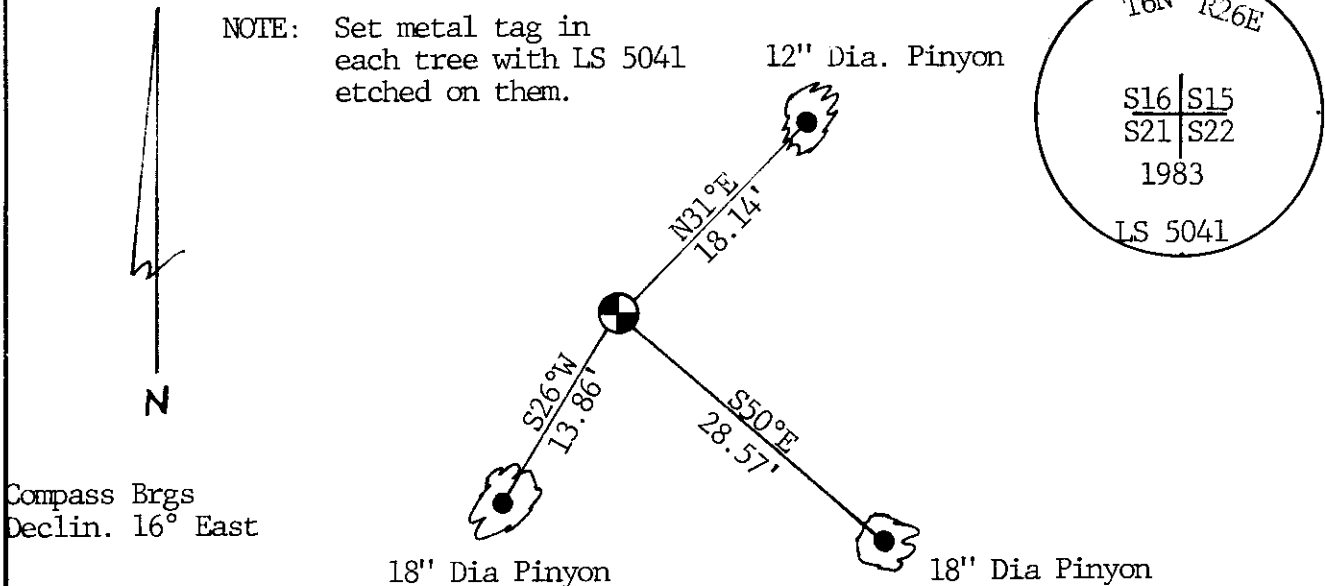

SURVEYOR'S CERTIFICATE

THIS CORNER RECORD WAS PREPARED BY ME OR UNDER MY DIRECTION IN CONFORMANCE WITH THE LAND SURVEYORS ACT ON August 16 19 83

SIGNED: James H. Luke

L.S. or R.C.E. No.: LS 5041

SEAL

COUNTY SURVEYOR'S CERTIFICATE

THIS CORNER RECORD WAS RECEIVED Nov. 8 19 84 AND EXAMINED AND FILED Dec. 1 19 84

BY: Richard Boardman

TITLE: Deputy County Surveyor

DOCUMENT No. 6N-26-15-1

STATEMENT ON BACK OF SHEET

PHOTO

YES ☒ NO ☐