

**SURVEYOR'S STATEMENT**

This map was prepared by me or under my direction and is based upon a field survey in conformance with the requirements of the Subdivision Map Act and local ordinance at the request of

ERIN STORM on 2/12, 1993

I hereby state that this parcel map substantially conforms to the approved or conditionally approved tentative map, if any, and the monuments are of the character and in the locations shown hereon, and that said monuments are sufficient to enable the survey to be traced.



PREVIOUSLY OFFERED TO HWY 41  
STEPHEN L. JONES, C.S. 4218 EXP. 12/31/95

(1.577'52") R.M.  
(1.463'32") R.M.  
(1.471'32") R.M.  
(1.400'00") R.M.  
(1.406'15") R.M.  
(1.452'14'30") R.M.  
(1.436'26") R.M.  
(1.423'34") R.M.  
(1.474'55'50") R.M.  
(1.474'00") R.M.  
(1.428'43") R.M.  
(1.414'00'29") R.M.  
(1.416'00") R.M.

**LEGEND**

- MONUMENTS: 9/8 REBAR 1/4" DIA. UNLESS NOTED
- MONUMENTS SET, 3/8" x 30" REBAR 2.5, 4298, UP 4"
- BOUNDARY OF ORIGINAL PARCEL
- NEW DIVISION LINE
- RECORD DATA AS PER P.M. #304, BK. 41, PG. 4, M.C.R.
- R.M. RECORD AND MEASURED

**BASIS OF BEARINGS**

BEING THE EAST LINE OF PARCEL # OF PARCEL MAP #3184, BK. 41, PG. 4, M.C.R., LOCATED IN THE SE 1/4 OF SECTION 17, T4S, R2E, M2B, 4M, WHICH BEARS: N 0° 20' 01" W.

A 60 FOOT WIDE ROAD RIGHT OF WAY PREVIOUSLY OFFERED FOR DEDICATION TO THE COUNTY OF MADERA IN VOL. 1928, AT PG. 299-302, M.C.R.

"NOTE! THE APPLICANT AND/OR SUCCESSORS INTEREST SHALL BE RESPONSIBLE FOR ANNUAL MAINTENANCE OF ALL FIRE-SAFE FEATURES AS REQUIRED AND ADMINISTERED BY THE CALIFORNIA DEPARTMENT OF FORESTRY AND FIRE PROTECTION UNDER THE PROVISIONS OF PUBLIC CODE SECTION 4290."

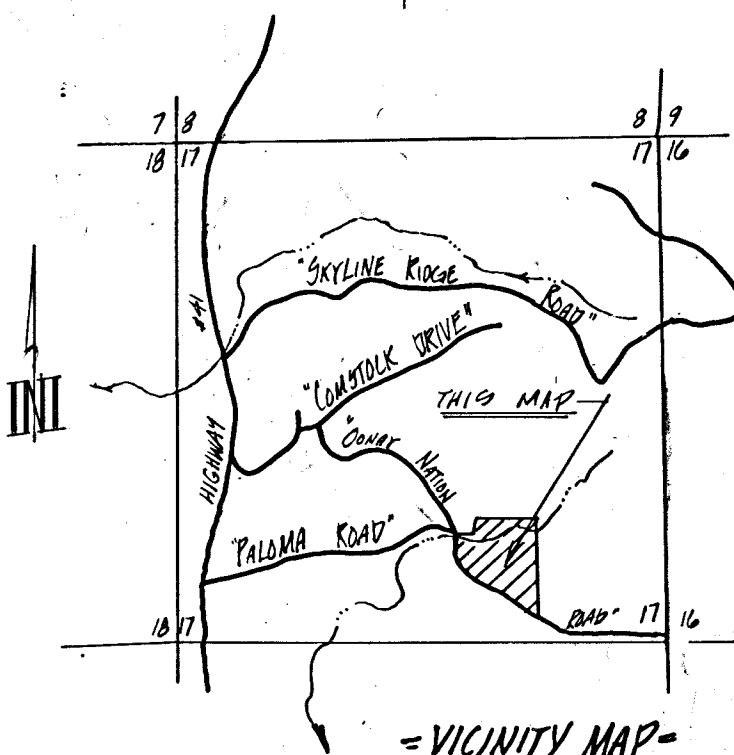
**VICINITY MAP**

1" = 2000' ±  
SEC. 17, T4S  
R2E, M2B, 4M

**COUNTY SURVEYOR'S STATEMENT**

STATE OF CALIFORNIA  
COUNTY OF MADERA

I, DOWE STINSON, COUNTY ENGINEER OF MADERA COUNTY, HEREBY CERTIFY THAT I HAVE EXAMINED THIS MAP THAT THE SUBDIVISION HEREON IS SUBSTANTIALLY THE SAME AS IT APPEARS ON THE APPROVED TENTATIVE MAP THAT THE MAP COMPLIES WITH THE PROVISIONS OF THE "SUBDIVISION MAP ACT" STATE OF CALIFORNIA STATUTES OF 1992 AND ALL COUNTY ORDINANCES AND THAT I AM SATISFIED THAT THE MAP IS TECHNICALLY CORRECT.

DATED: 2-25-93

Dowe Stinson  
MADERA COUNTY ENGINEER, RLE 15901

**RECORDER'S CERTIFICATE**

Filed this 16th day of NOVEMBER, 1993 at P.M.  
in Book 41 of Maps at page 132 of  
Madera County Records at the request of  
Jones and Snyder Surveying  
Fee \$6.00

REBECCA MARTINEZ  
County Clerk, Recorder  
By Michael D. Red  
Deputy  
Doc. #9331389

**PARCEL MAP NO. 3466**

ERIN J. STORM

BEING A REVISION OF PARCEL #3 OF PARCEL MAP #3184, BOOK 41, AT PG. 4, M.C.R., LOCATED IN THE SOUTHEAST 1/4 OF SECTION 17, TOWNSHIP 4 SOUTH, RANGE 21 EAST, M2B, 4M.

CONTAINING 16.73 ACRES

MADERA COUNTY

CALIFORNIA

**APPLICANT'S CERTIFICATE**

I hereby apply for approval of the division of real property shown on this parcel map and certify that I am the legal owner of said property and that the information shown hereon is true and correct to the best of my knowledge and belief.

Legal Owner ERIN J. STORM  
Address 2004 N. LAUREN FRESNO CA 93703  
Telephone (209) 436-8779  
Date 7-16-93

**NOTARY CERTIFICATES**

State of California  
County of Madera

ON 7-16-93 BEFORE ME, TERI LYNN GRAHAM

NOTARY PUBLIC, PERSONALLY APPEARED ERIN J. STORM  
PERSONALLY KNOWN TO ME (OR PROVED TO ME ON BASIS OF SATISFACTORY EVIDENCE) TO BE THE PERSON(S) WHOSE NAME(S) IS/ARE SUBSCRIBED TO THE WITHIN INSTRUMENT AND ACKNOWLEDGED TO ME THAT HE/SHE/ THEY EXECUTED THE SAME IN HIS/HER/ THEIR AUTHORIZED CAPACIT(IES), AND THAT BY HIS/HER/ THEIR SIGNATURE(S) ON THE INSTRUMENT THE PERSON(S), OR THE ENTITY UPON BEHALF OF WHICH THE PERSON(S) ACTED, EXECUTED THE INSTRUMENT.  
WITNESS MY HAND.

TERI LYNN GRAHAM March 31, 1995  
SIGNATURE NOT COMMISSION EXPIRES

NOTE! THIS PROPERTY IS SUBJECT TO THE FOLLOWING CONDITIONS AS PER LIT. GUARANTEE # 502999, (CHICAGO TITLE) OWNERS: ERIN J. STORM

- 1) A DEED OF TRUST HELD BY CHICAGO TITLE COMPANY AS TRUSTEE, RECORDED AS VOL. # 912481 OF O.K.
- 2) RESERVATIONS CONTAINED IN THE DEED FROM THE UNITED STATES OF AMERICA, RECORDED IN VOL. 661, PG. 86, OF O.K.
- 3) AN EASEMENT GRANTED TO SAN JUAN LIGHT & POWER CORPORATION, RECORDED IN VOL. 64 OF DEEDS, PG. 26 OF O.K.
- 4) A DEED OF DISTRIBUTION AS RECORDED IN VOL. 104, PG. 421 OF O.K.
- 5) AN EASEMENT GRANTED TO PACIFIC GAS & ELECTRIC, RECORDED IN PG. 996, PG. 108, AS VOL. # 12590, OF O.K.
- 6) AN OFFER OF DEDICATION GRANTED TO THE COUNTY OF MADERA, RECORDED IN PG. 1928, PG. 299-296, AS VOL. # 9056, OF O.K.
- 7) AN EASEMENT GRANTED TO ALEX B. WILCOX AS RECORDED IN BK. 1194, PG. 941, AS VOL. # 28128, OF O.K.
- 8) AN EASEMENT GRANTED TO JAMES E. & JEANINE W. BRUER, RECORDED IN BK. 1241, PG. 270, AS VOL. # 91182, OF O.K.
- 9) AN EASEMENT GRANTED TO JAMES A. BROWER, RECORDED AS VOL. # 20-19249, OF O.K.
- 10) COVENANTS, CONDITIONS AND RESTRICTIONS RECORDED AS VOL. # 9302699, OF O.K.
- 11) A RIGHT-TO-FARM NOTICE RECORDED AS VOL. # 9304198, OF O.K.
- 12) COVENANTS, CONDITIONS AND RESTRICTIONS, RECORDED AS VOL. # 9302941, OF O.K.

Jones and Snyder Surveying  
Oakhurst, Ca po box 2292  
683-7661

JN. 93-022 PG. 70+80 PG. 80+90 D192. 90A (J)