

D:\Chicago-Jobs\Panda\IN\S8-21-D8044 - IN, Greenfield, State St & New Rd\3-A&E\2-CDs\CAD\A-100_Arch-Site-Plan-2300_True Warm and Welcome.dwg, 5/6/2021 1:41:06 PM, AutoCAD PDF (General Documentation).pc3

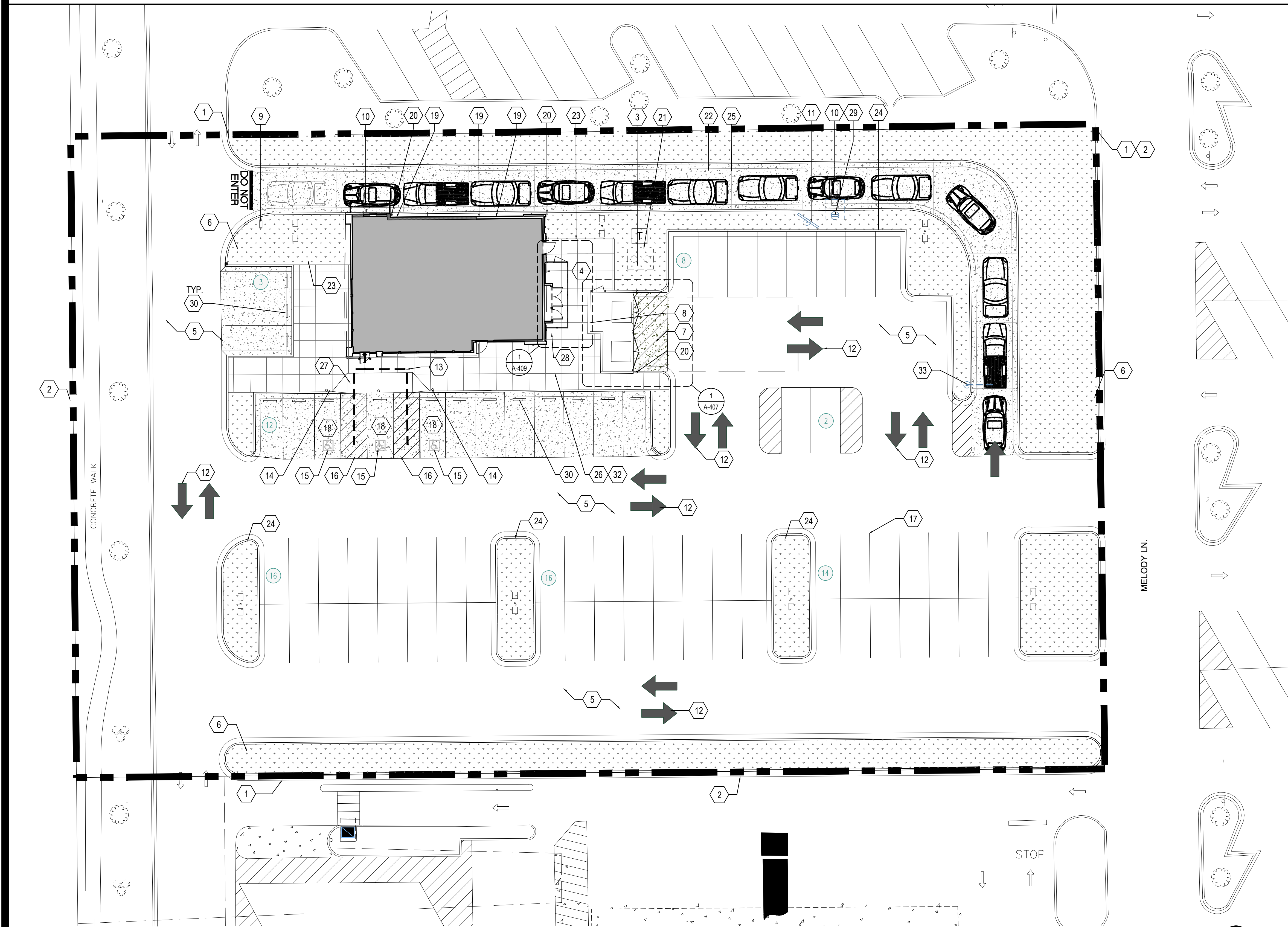

- DEMOLITION NOTE:**
G.C. TO REMOVE ALL EXISTING ABOVE/UNDER GROUND STRUCTURAL WALLS, FOUNDATION, ASPHALT, CONC. CURBS AND DEBRIS PRIOR TO NEW CONSTRUCTION.
- GENERAL NOTE:**
1. G.C. TO VERIFY AND PROVIDE ALL UNDERGROUND WIRING AND CONDUIT(INSTALLED BY LOCAL UTILITY COMPANY) FROM TRANSFORMER TO ELECTRICAL MAIN SWITCHGEAR, DRIVE THRU- MENU BOARD, BY G.C. VERIFY WITH PANDA PM.
2. WATER METER FOR IRRIGATION SHALL BE A SEPARATE METER THAN MAIN WATER METER. G.C. TO REFERENCE CIVIL UTILITY PLAN FOR SIZE AND LOCATION.
3. PROVIDE & INSTALL CAGE AND COVER FOR THE BACK-FLOW PREVENTER AT 4" CONCRETE CURB IN LANDSCAPE AREA, GORILLA CAGE, MANUFACTURED BY HOUSTON IRRIGATION SERVICES SPRING, TEXAS (281-705-9701). PROVIDE INSULATED COVER, 'AQUA SHIELD' MODEL # BFP1-S FOR COLDER REGIONS OF US. COORDINATE WITH PANDA PM. REFER TO DETAIL 11/ A-407
4. FOR HORIZONTAL CONTROL PLAN REFER TO CIVIL DRAWINGS
- 1 LIMIT OF CONSTRUCTION
2 PROPERTY LINE
3 NEW TRANSFORMER PAD
4 NEW SWITCHGEAR
5 PAVING - SEE CIVIL PLAN
6 IRRIGATED LANDSCAPING, REFER TO LANDSCAPE DRAWINGS
7 HEAVY DUTY CONCRETE APRON FOR DUMPSTER ENCLOSURE. REFERENCE CIVIL DRAWINGS FOR SPECIFICATIONS
8 TRASH ENCLOSURE, CONFIRM BIN SIZE WITH LOCAL WASTE MANAGEMENT COMPANY. 01 A-407
9 THANK YOU DIRECTIONAL
10 DRIVE THRU LANE SENSOR LOOP. INSTALL/POSITION SO LOOP IS CENTERED ON ACTIVE PANEL OF DRIVE THROUGH WINDOW. SEE DETAIL. 01 A-405
11 DRIVE THROUGH MENU BOARD-INSTALLED BY SIGN COMPANY. VERIFY WITH PANDA PM (SEE GENERAL NOTE ABOVE)
12 DIRECTIONAL ARROW
13 ACCESSIBLE PATH OF TRAVEL
14 ACCESSIBLE PARKING POLE SIGN
15 INTERNATIONAL ACCESSIBILITY SYMBOL @ PARKING SPACE
16 ACCESSIBLE PARKING SPACE AND LOADING ZONE PAINT LOADING ZONE W/ 4" WIDE STRIPES @3'-0" O.C.
17 PAINT 4" WIDE SOLID PARKING STRIPING W/ TWO (2) COATS HIGHWAY WHITE PAINT
18 DESIGNATED HANDICAP PARKING SPACE
19 ROOF DRAIN AND OVERFLOW DRAIN FROM ROOF TO EXIT TO DAYLIGHT THRU FACE OF WALL. COLD CLIMATES WILL REQUIRE CONNECTION TO STORM SEWER. ARCHITECT TO VERIFY WITH LOCAL JURISDICTION.
20 STEEL PIPE BOLLARD. BOLLARDS TO BE PAINTED SAFETY YELLOW PRIOR TO APPLICATION OF LDPE SLEEVE. 18 A-407
21 UNDERGROUND GREASE INTERCEPTOR - SEE PLUMBING/CIVIL DRAWINGS
22 CONC. DRIVEWAY
23 EDGE OF SIDEWALK AT PLANTER
24 CONCRETE CURB AT LANDSCAPE AREA
25 EXPANSION JOINT @ 20'-0" O.C. MAX.
26 TOOLED JOINTS @ 5'-0"x5'-0" O.C. EXPANSION JOINT @ 20'-0" O.C.
27 ACCESSIBLE RAMP
28 EQUIPMENT SCREEN. 1 A-405
29 ORDER CONFIRMATION BOARD
30 RUBBER WHEEL STOP, REF. CIVIL DRAWINGS
31 NOT USED.
32 SEALED CONC SIDEWALK. (AQUA MIX SEALER'S CHOICE GOLD). CONCRETE TO BE LIGHT BROOM TEXTURE FINISH. PROVIDE UNDER SLAB TREATMENT PER SOIL REPORT. PROVIDE POSITIVE DRAINAGE AWAY FROM BLDG.
33 CLEARANCE BAR/BASE INSTALLED BY SIGN VENDOR.

SITE PLAN 1
Scale= 1/16" = 1'-0" A-100

KEY NOTES A
Scale= NTS A-100



PANDA EXPRESS, INC.
1683 Walnut Grove Ave.
Rosemead, California
91770
Telephone: 626.799.9898
Facsimile: 626.372.8288

All ideas, designs, arrangement and plans indicated or represented by this drawing are the property of Panda Express Inc. and were created for use on this specific project. None of these ideas, designs, arrangements or plans may be used by or disclosed to any person, firm, or corporation without the written permission of Panda Express Inc.

REVISIONS:	
1	
2	
3	
4	
5	
6	
7	
8	
9	
10	
11	
12	
13	
14	
15	
16	
17	
18	
19	
20	
21	
22	
23	
24	
25	
26	
27	
28	
29	
30	
31	
32	
33	

ISSUE DATE:
04/27/21 WALMART REVIEW
05/05/21 ISSUE FOR PERMIT

DRAWN BY: BL
PANDA PROJECT #: S8-22-D8044
PANDA STORE #: D8044
ARCH PROJECT #: Q511070001



NEWGROUND
15450 S OUTER FORTY DRIVE, SUITE 300
CHESTERFIELD, MO 63017
636-898-8100

PANDA EXPRESS
TRUE WARM & WELCOME
N STATE ROAD 9
GREENFIELD, IN 46140

A-100
SITE PLAN
ARCHITECTURAL

TRUE WARM & WELCOME 2300 R5