

OWNERSHIP STATEMENT

We the undersigned, being all parties having any record title interest in the real property being subdivided, do hereby consent to the preparation and recordation of this final map.

As owners:
Robbie Presson and Heidi Presson, husband and wife as community property

BY: Robbie Presson
Robbie Presson

Heidi Presson
Heidi Presson

As Trustees:
Inyo-Mono Title Company, a California Corporation, trustee under deed of trust recorded as Instrument No. 2003013847 on December 29, 2003 in the Official Records of Mono County.

BY: James D. Core
James D. Core
President, Inyo-Mono Title Company

State of California)
County of Mono) ss.

On January 5, 2005 before me,
Janice Mary Johnson
a Notary Public in and for said County and State, personally appeared

Robbie Presson and Heidi Presson

☒ personally known to me - OR - ☐ proved to me on the basis of satisfactory evidence to be the persons whose names are subscribed to the within instrument and acknowledged to me that they executed the same in their authorized capacities, and that by their signatures on the instrument the persons, or the entity upon behalf of which the persons acted, executed the instrument.

WITNESS my hand and (optional) official seal:

Janice Mary Johnson Janice Mary Johnson
Notary Public (sign) and print name)
My commission expires: Oct. 25, 2006
County of my principal place of business: MONO

State of CA)
County of Mono) ss.

On February 8, 2005 before me,
J.A. Markham
a Notary Public in and for said County and State, personally appeared

James D. Core

☒ personally known to me - OR - ☐ proved to me on the basis of satisfactory evidence to be the person whose name is subscribed to the within instrument and acknowledged to me that he executed the same in his authorized capacity, and that by his signature on the instrument the person, or the entity upon behalf of which the person acted, executed the instrument.

WITNESS my hand and (optional) official seal:

J.A. Markham
Notary Public (sign) and print name)
My commission expires: 4-10-06
County of my principal place of business: MONO

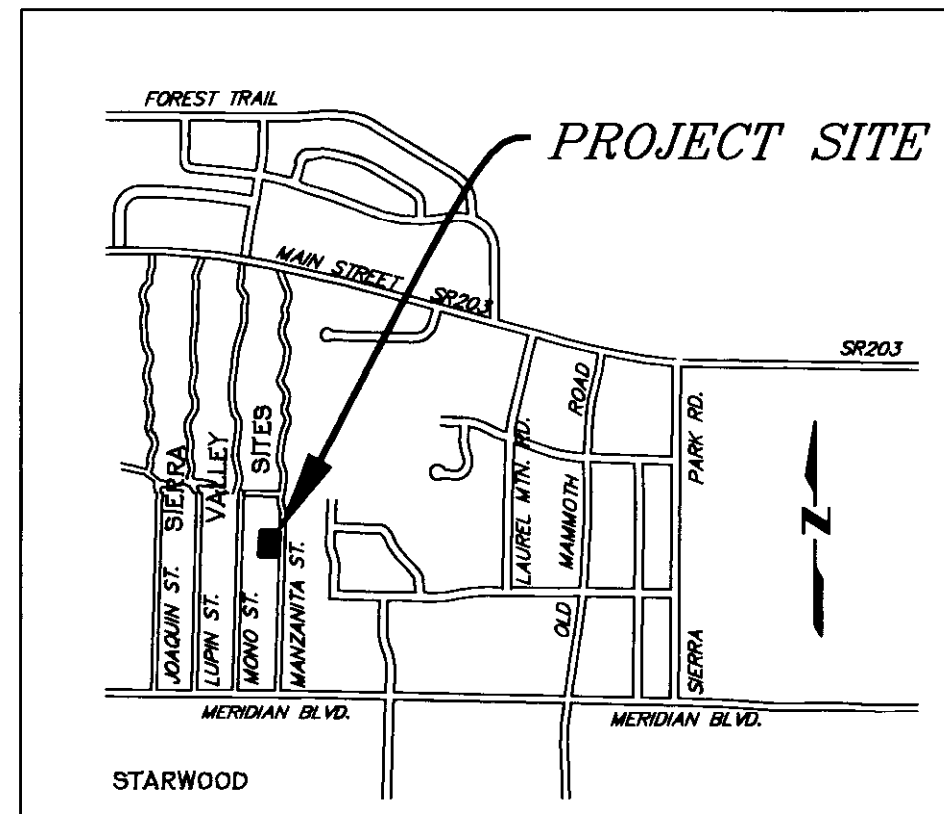

VICINITY MAP

PLANNING COMMISSION'S CERTIFICATE

This Final Map has been reviewed by the Town of Mammoth Lakes Planning Commission at its meeting of January 12, 2005. The Commission found the Final Map to be in substantial conformance with the approved or conditionally approved tentative map and any amendments thereto.

Therefore, in accordance with the provisions of the Town of Mammoth Lakes Ordinance 84-10, Section 17.20.170 as amended by Town of Mammoth Lakes Ordinance 97-06, Section 1-20.170, this Final Map is hereby approved.

Date: February 9, 2005

By: William T. Taylor
William T. Taylor
Secretary to the Planning Commission

SOILS NOTE

A soils report Project No. 3.30512, dated April 26, 2004, was prepared by Sierra Geotechnical Services, Inc., under the signature of Thomas A. Platz, R.C.E. 41039. Said report is on file with the Town of Mammoth Lakes Public Works Department - Engineering Services Division.

TAX COLLECTOR'S CERTIFICATE

I hereby certify that, according to the records on file in this office, there are no liens against this subdivision, or any part thereof, for unpaid state, county, municipal, local taxes or special assessments collected as taxes, except taxes or special assessments not yet payable. Taxes or special assessments collected as taxes which are a lien but not yet payable are estimated to be in the amount of \$26,804.48 for which receipt of good and sufficient securities conditioned upon payment of these taxes is hereby acknowledged.

Shirley A. Cranney
Mono County Tax Collector

2/23/05
Date

By: Raymond
Deputy Mono County Tax Collector

C.C. & R.'s NOTE

The declarations of covenants, conditions, restrictions and reservations are recorded as Instrument Number 2005001429 of Official Records on file in the office of the Mono County Recorder.

RECORDER'S CERTIFICATE

Filed this 24th day of February, 2005 at 9:13 A.m., in Book 10 of Tract Maps at Page 85-85A, at the request of Robbie and Heidi Presson

Instrument No. 2005001428 Fee: \$10.00

Renn Nolan
Mono County Recorder

By: Sherrin A. Hale
Deputy Mono County Recorder

SURVEYOR'S STATEMENT

This map was prepared by me or under my direction and is based upon a field survey in conformance with the requirements of the Subdivision Map Act and local ordinance at the request of Robbie Presson in August, 2004. I hereby state that this Final Map substantially conforms to the approved or conditionally approved tentative map. I hereby state that all the monuments are of the character and occupy the positions indicated, or will be set in such positions on or before June 1, 2006, and that such monuments are sufficient to enable the survey to be retraced.

January 9, 2005
Date

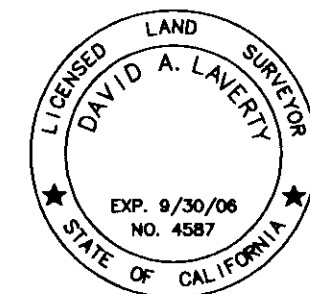

David A. Lavery
David A. Lavery L.S. 4587
Lic. exp. 9/30/06

TOWN ENGINEER'S STATEMENT

This Final Map was examined by me and the subdivision as shown is substantially the same as it appears on the tentative map and any approved alterations thereof. All provisions of the Subdivision Map Act and any local ordinances applicable at the time of approval of the tentative map, have been complied with. This final map was examined by me and I am satisfied that this map is technically correct.

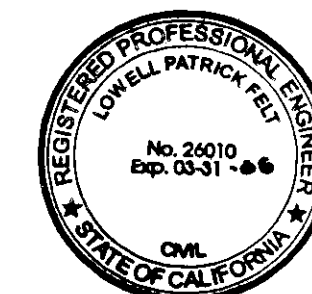

Lowell P. Fell 1-06-05
LOWELL P. FELL, RCE 26010 Date
Mammoth Lakes Town Engineer
License Expires 3/31/06

SIGNATURE OMISSIONS

The signatures of the following companies, their successors and assigns, owners of easements as disclosed by the following deeds recorded in the Official Records of Mono County, have been omitted under the provisions of Section 66436 Subsection a-3Ai of the Subdivision Map Act:

Southern California Edison Company

Book 84, Page 30 of Official Records

MANZANITA RIDGE
TRACT NO. 36-221

A PLANNED UNIT DEVELOPMENT

IN THE TOWN OF MAMMOTH LAKES, MONO COUNTY, CALIFORNIA
A SUBDIVISION OF PARCEL 1 OF PARCEL MAP NO. 36-191,
AS PER MAP RECORDED IN BOOK 4, PAGE 127 OF PARCEL
MAPS IN THE OFFICE OF THE COUNTY RECORDER OF SAID
COUNTY.

GROSS AREA 0.23± ACRES